



Valley Hospital
Ridgewood • NJ

Expansion Feasibility



BUCKL
ARCHITECTS

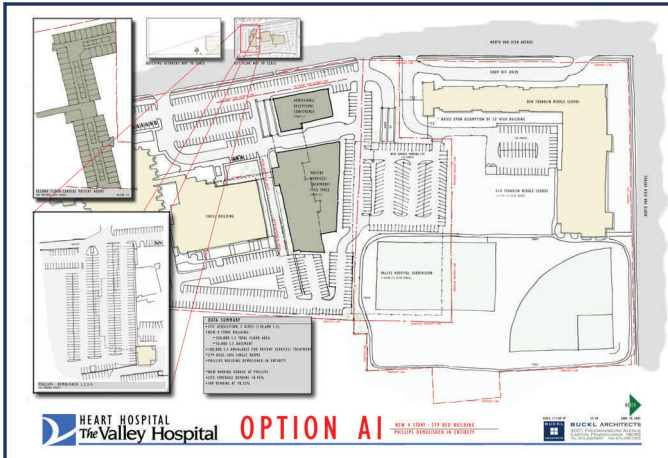

Existing Conditions

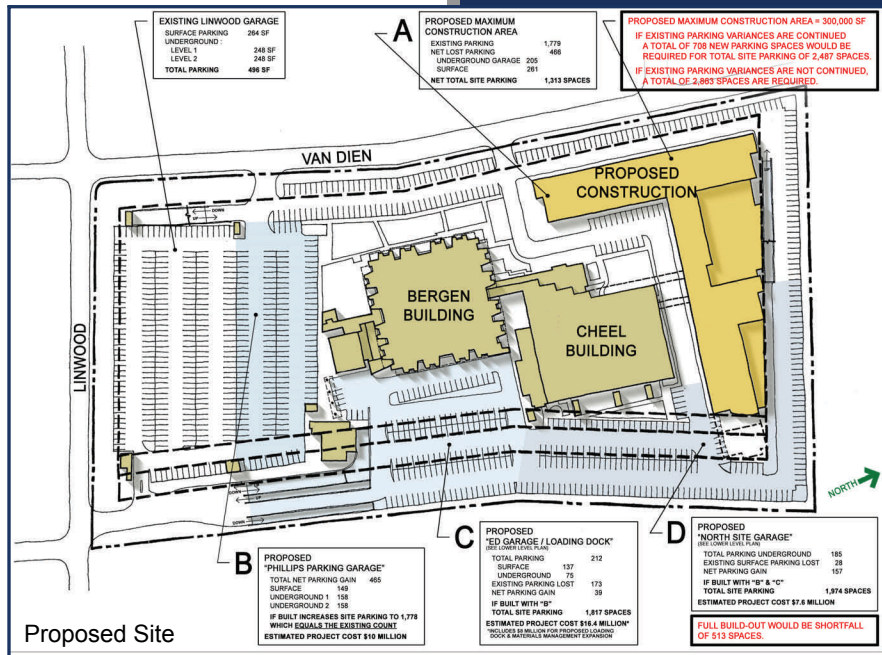
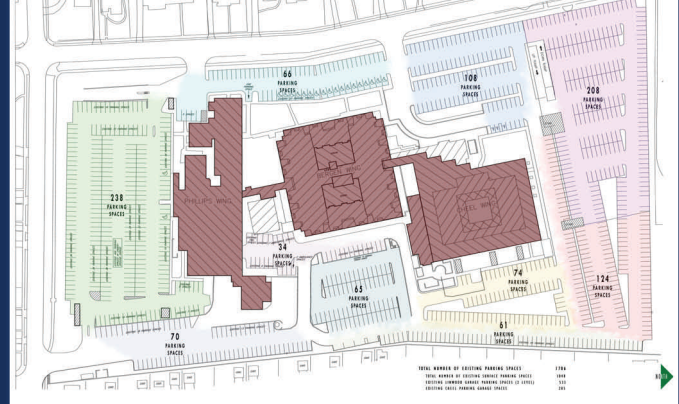

"...potential to include as much as a 300,000 sf four story building, to increase the bed count by 100 single rooms and 75,000 sf of expansion floor space for other programs..."

Confined by a site maximized to zoning standards and confronted by the need to accommodate growth, The Valley Hospital sought expansion by means of acquisition of 5 acres of adjacent school property to be perpetually leased back to the school district. TVH retained BA for an Expansion Feasibility Study to evaluate the potential to include as much as a 300,000 sf four story building, to increase the bed count by 100 single rooms and 75,000 sf of expansion floor space for other programs and services. In addition, the evaluation included the proposal for the construction of an underground parking garage to alleviate parking shortfalls. The garage was to be situated below the school's playing fields that were to be reconstructed with state of the art synthetic surface.

Project Team
Buckl Architects
Torcon, Inc. Construction Managers

Project Area
570,000 sf Existing Building
300,000 sf Proposed
15.4 acres existing
5 to 6 acres to be acquired
site acquisition

Completion Date
2004