

**Ambulatory Care Building**

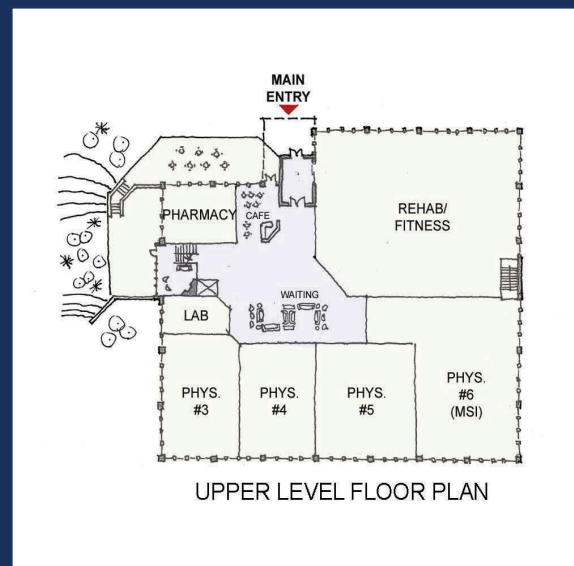

*“...an indoor/outdoor cafe and healing gardens are very accommodating feature to both patients and staff, along with its atrium-like common waiting area.”*

The main concept of this Ambulatory Care Building was to develop an out-patient satellite campus for Greater Hazleton Health Alliance, developed by Anchor Health Properties. This 2-story and 70,000 sf space will facilitate a 12,800 sf Ambulatory Surgery Center, 8,100 sf Imaging Center, 11,000 sf Rehab/Fitness Center, Pharmacy, Lab, Sleep Lab, and multiple physician suites. With a focused aim to produce a convenient and patient friendly environment, an indoor/outdoor cafe and healing gardens are very accommodating feature to both patients and staff, along with an atrium-like common waiting area. The Ambulatory Care Building will be nestled into the grade allowing grade level entry on both floors.

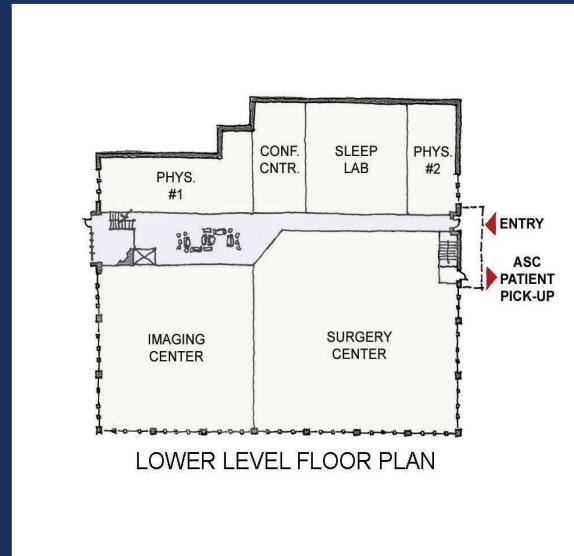

**Project Team**

Buckl Architects  
Lehigh Valley Engineering  
O'Donnell & Naccarato, Inc  
Sordoni Construction

**Project Area**

70,000 sf

**Completion Date**

2007